

Model	mm	Max. punching force	Gas spring return force		Gas spring model	Max. working specifications		Max. width of driver	Kg
			Initial	Final		Velocity	Strokes / min		
RTRC 2000x50	50	2000 daN	140 daN	≈ 210 daN	MICRO 19x50	0,5 m/s	35	25 mm	3,95

Working Force Distribution

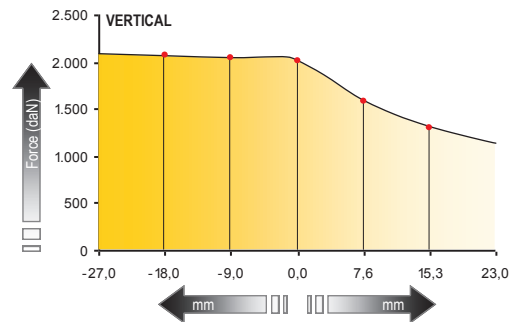
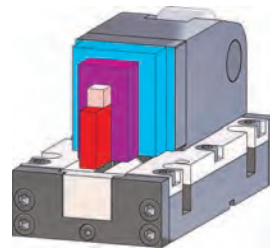
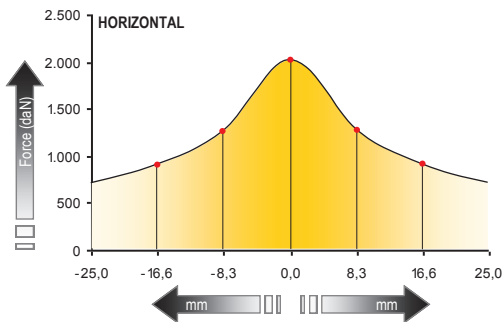

Maximum force that can be applied to the punch depending on eccentricity, so that the stress in the assembly is the same as it was when the punch was completely centred.

Maximum Incline

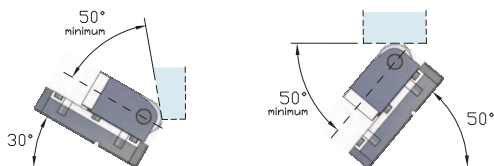

How to order

RTRC 2000	x	50
Model		Stroke