

### Mold Guide Pins, INCH

Nominal Pin Ø	L1 overall length	L3	Catalog Number
3/4"	1 3/4	7/8	6-16-MP
	2 1/4	7/8	6-22-MP
	2 3/4	7/8	6-26-MP
	3 1/4	7/8	6-32-MP
	3 3/4	7/8	6-36-MP
	4 1/4	1 3/8	6-42-MP
	4 3/4	1 3/8	6-46-MP
	5 1/4	1 3/8	6-52-MP
	5 3/4	1 7/8	6-56-MP
	6 1/4	1 7/8	6-62-MP
	6 3/4	1 7/8	6-66-MP
	7 1/4	1 7/8	6-72-MP
7 3/4	1 7/8	6-76-MP	
7/8"	1 3/4	7/8	7-16-MP
	2 1/4	7/8	7-22-MP
	2 3/4	7/8	7-26-MP
	3 1/4	7/8	7-32-MP
	3 3/4	7/8	7-36-MP
	4 1/4	1 3/8	7-42-MP
	4 3/4	1 3/8	7-46-MP
	5 1/4	1 3/8	7-52-MP
	5 3/4	1 3/8	7-56-MP
	6 1/4	1 7/8	7-62-MP
	6 3/4	1 7/8	7-66-MP
	7 1/4	1 7/8	7-72-MP
7 3/4	1 7/8	7-76-MP	
8 1/4	1 7/8	7-82-MP	
8 3/4	1 7/8	7-86-MP	
9 1/4	1 7/8	7-92-MP	
1"	1 3/4	7/8	8-16-MP
	2 1/4	7/8	8-22-MP
	2 3/4	7/8	8-26-MP
	3 1/4	7/8	8-32-MP
	3 3/4	7/8	8-36-MP
	4 1/4	1 3/8	8-42-MP
	4 3/4	1 3/8	8-46-MP
	5 1/4	1 3/8	8-52-MP
	5 3/4	1 3/8	8-56-MP
	6 1/4	1 3/8	8-62-MP
	6 3/4	1 7/8	8-66-MP
	7 1/4	1 7/8	8-72-MP
7 3/4	1 7/8	8-76-MP	
8 1/4	1 7/8	8-82-MP	
8 3/4	1 7/8	8-86-MP	
9 1/4	1 7/8	8-92-MP	
9 3/4	1 7/8	8-96-MP	
10 1/4	1 7/8	8-102-MP	
10 3/4	1 7/8	8-106-MP	
11 1/4	1 7/8	8-112-MP	
11 3/4	1 7/8	8-116-MP	
12 1/4	1 7/8	8-122-MP	

3/4" - 1 1/2" dia. have taper length of 1/4".  
2" - 2 1/2" have taper length of 3/8".  
3" pins have XX radius.

Nominal Pin Ø	L1 overall length	L3	Catalog Number
1 1/4"	2 3/4	7/8	10-26-MP
	3 1/4	7/8	10-32-MP
	3 3/4	7/8	10-36-MP
	4 1/4	7/8	10-42-MP
	4 3/4	1 3/8	10-46-MP
	5 1/4	1 3/8	10-52-MP
	5 3/4	1 3/8	10-56-MP
	6 1/4	1 3/8	10-62-MP
	6 3/4	1 7/8	10-66-MP
	7 1/4	1 7/8	10-72-MP
	7 3/4	1 7/8	10-76-MP
	8 1/4	1 7/8	10-82-MP
8 3/4	1 7/8	10-86-MP	
9 1/4	1 7/8	10-92-MP	
9 3/4	1 7/8	10-96-MP	
10 1/4	1 7/8	10-102-MP	
10 3/4	1 7/8	10-106-MP	
11 1/4	1 7/8	10-112-MP	
11 3/4	1 7/8	10-116-MP	
12 1/4	1 7/8	10-122-MP	
12 3/4	1 7/8	10-126-MP	
13 3/4	1 7/8	10-136-MP	
14 3/4	1 7/8	10-146-MP	
15 3/4	1 7/8	10-156-MP	
1 1/2"	3 3/4	1 3/8	12-36-MP
	4 1/4	1 3/8	12-42-MP
	4 3/4	1 3/8	12-46-MP
	5 1/4	1 3/8	12-52-MP
	5 3/4	1 3/8	12-56-MP
	6 1/4	1 3/8	12-62-MP
	6 3/4	1 3/8	12-66-MP
	7 3/4	1 7/8	12-76-MP
	8 3/4	1 7/8	12-86-MP
	9 3/4	1 7/8	12-96-MP
	10 3/4	1 7/8	12-106-MP
	11 3/4	1 7/8	12-116-MP
12 3/4	1 7/8	12-126-MP	
13 3/4	1 7/8	12-136-MP	
14 3/4	1 7/8	12-146-MP	
15 3/4	1 7/8	12-156-MP	
2"	5 3/4	1 7/8	16-56-MP
	6 3/4	1 7/8	16-66-MP
	7 3/4	1 7/8	16-76-MP
	8 3/4	1 7/8	16-86-MP
	9 3/4	1 7/8	16-96-MP
	10 3/4	1 7/8	16-106-MP
	11 3/4	1 7/8	16-116-MP
	12 3/4	1 7/8	16-126-MP
	13 3/4	1 7/8	16-136-MP
	14 3/4	1 7/8	16-146-MP
	15 3/4	1 7/8	16-156-MP
	16 3/4	1 7/8	16-166-MP
18 3/4	1 7/8	16-186-MP	

Nominal Pin Ø	L1 overall length	L3	Catalog Number
2 1/2"	5 3/4	2 3/8	20-56-MP
	6 3/4	2 3/8	20-66-MP
	7 3/4	2 3/8	20-76-MP
	8 3/4	2 3/8	20-86-MP
	9 3/4	2 3/8	20-96-MP
	10 3/4	2 3/8	20-106-MP
	11 3/4	2 3/8	20-116-MP
	12 3/4	2 3/8	20-126-MP
	13 3/4	2 3/8	20-136-MP
	14 3/4	2 3/8	20-146-MP
	15 3/4	2 3/8	20-156-MP
	16 3/4	2 3/8	20-166-MP
18 3/4	2 3/8	20-186-MP	
3"	8 3/4	2 7/8	24-86-MP
	10 3/4	2 7/8	24-106-MP
	12 3/4	2 7/8	24-126-MP
	14 3/4	2 7/8	24-146-MP
	16 3/4	2 7/8	24-166-MP
	18 3/4	2 7/8	22-186-MP

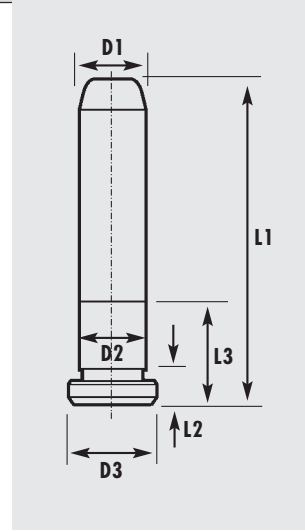

### General Dimensions

Nom. I.D.	D1	D2	D3	L2
	+0.005 -0.000	+0.005 -0.000	+0.000 -0.005	+0.000 -0.005
3/4	0.749	0.7510	0.990	0.1870
7/8	0.874	0.8760	1.115	0.2500
1	0.999	1.0010	1.240	0.2500
1 1/4	1.249	1.2510	1.490	0.3120
1 1/2	1.499	1.5010	1.740	0.3120
2	1.999	2.0010	2.240	0.3120
2 1/2	2.499	2.5010	2.740	0.3120
3	2.999	3.0010	3.365	0.5000